

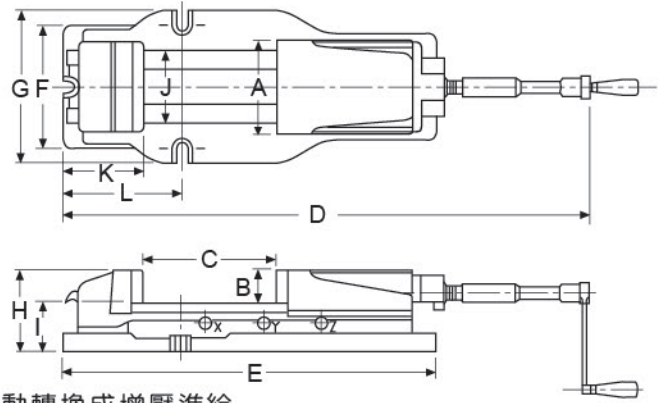

35050

油壓虎鉗 HYDRAULIC MACHINE VISE

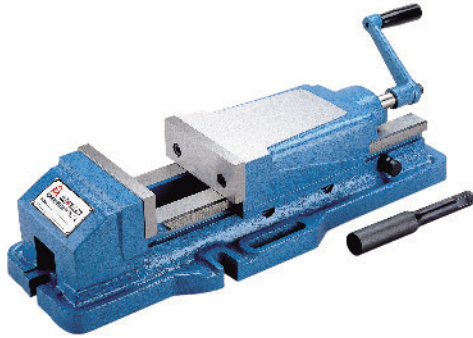

- 內藏式油壓.增壓設計,只要以瞬間之力輕敲把手,即自動轉換成增壓進給.
- 本體和固定虎口為一體成形,FC30鑄鐵製造,剛性強不易變形.
- 虎鉗滑面熱處理HRC45度以上,並經精密研磨.
- Hydraulic inside, pressure designed, just light knock handle by wink power. It auto change to pressure enter.
- The body and fixed clamping are unity, manufactured by FC30 iron cast, rigidity is strong not easy to change shape.
- Slipping side of vise heat treatment up HRC 45° up, and grind precision.

單位: mm

訂購編號 Order No.	型號 Model	A	B	C	D	E	F	G	H	I	J	K	L	X	Y	Z	夾持力(kgf) Power	重量(kg) Weight
35050-04	HV400	105	36	0~170	525	440	135	170	95	58	80	95	147	0~57	55~114	112~170	2500	21
35050-05	HV500	130	48	0~220	670	550	175	207	120	70.5	97	107	195	0~73	72~146	145~220	3000	38
35050-06	HV600	150	53	0~300	800	620	182	225	135	82.5	116	117	210	0~100	98~200	198~300	4500	53
35050-08	HV800	200	62	0~300	900	680	260	280	162	100	160	150	260	0~100	99~200	198~300	8000	95

35051

後開口油壓虎鉗 PRECISION HYDRAULIC & ANGLE LOCK VISE

● AHV-160

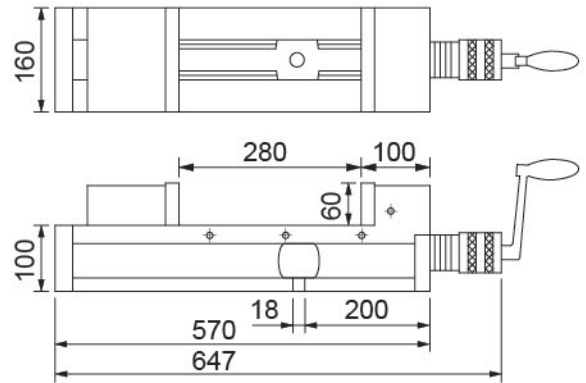
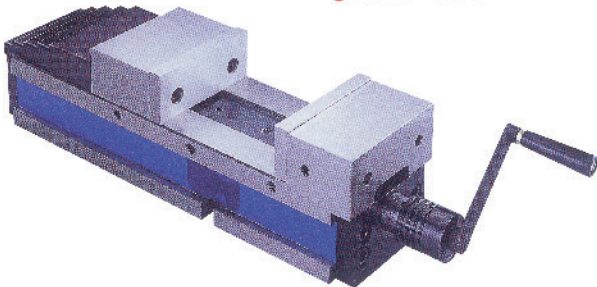

- 虎鉗活動鉗口位於後方,方便操作者縮短上下工件之距離.
- 適用於立式、臥式CNC銑床,作重切削精密加工使用.
- 角固式半圓球產生下鎖力,可消除虎口上浮和工件傾斜.
- 本體為球狀石墨化鑄鐵FCD60製造,抗張力強,不易變形.
- 虎鉗滑動面熱處理HRC45度以上,可保持長久耐磨及精度.
- 防塵蓋設計,可防止鐵屑進入傳動螺桿,引起的動作不良.
- 重量:60kg.

- Vise activities jaws in the rear of the vise, and facilitate the operator to shorten the distance of upper and lower.
- For vertical, horizontal CNC milling, precision machining for heavy cutting.
- There is the locking power of the ball-type semi-circular solid angle, and can eliminate the work piece tilted and the jaws floated.
- Vise is made of cast iron FCD60 with spherical graphite, and good anti tension, not deformed.
- The sliding surface of vise is heat treatment HRC45 degrees, can be maintained long-term wear and accuracy.
- The dust cover designed to prevent iron filings into the drive screw, causing the adverse action.
- Weight:60kg.

◆精度:

- 1.兩虎口板平行度 100mm/0.02mm內.
- 2.虎鉗底面滑動面平行度 100mm/0.01mm.
- 3.虎鉗側面與滑動面直角度 100mm/0.15mm.
- 4.工件夾緊後平行度 100mm/0.03mm內.

◆Accuracy:

- 1.The parallelism of jaws: 100mm/0.02mm
- 2.The parallelism of the sliding surface: 100mm/0.01mm.
- 3.The Verticality of side sliding surface: 100mm/0.15mm.
- 4.The parallelism after clamping the work piece:100mm/0.03mm.