

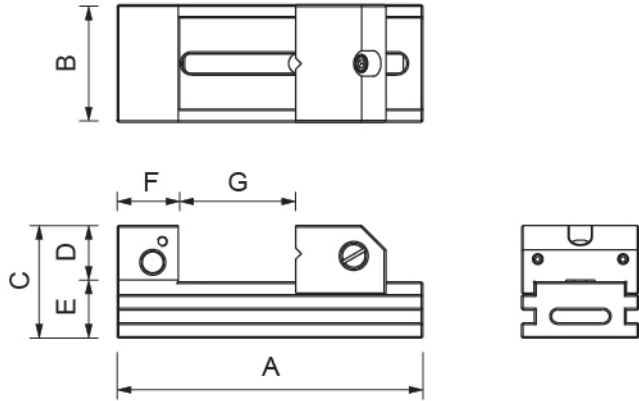

專利號碼 The patent No. : 151229

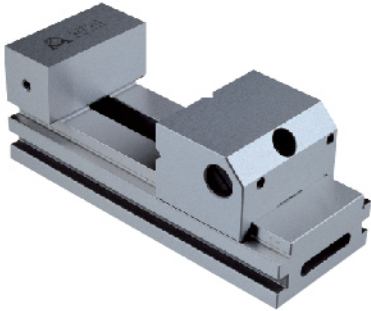

■規格:

- 材質 : SKS3
- 硬度 : HRC58°~60°
- 深冷處理 : -185°C
- 平行度 : 100mm/0.003mm內
- 垂直度 : 100mm/0.004mm內

■Feature:

- Material : SKS3
- Hardness : HRC58°~60°
- Cooling treatment : -185°C
- Parallelism within 0.003mm/100mm
- Squareness within 0.004mm/100mm

- VV型超精密工具萬力系列採用高級合金鋼製造。
- 專利設計夾持工件時防止主體結構變形，有效的確保工件夾持後工具萬力的精密度。
- 延續其專利旋轉彈簧活動設計，可輕易快速移動調整夾持位置。
- VV type super precision tool maker vise series, made of quality alloy steel.
- The patent designed to prevent the essence structure from deformed when clamping work piece. To ensure the precision of work piece after clamping.
- To continue the patent rotate spring designed, can be easy and quick to move and adjust clamping position.

單位:mm

訂購編號 Order No.	型號 Model	A	B	C	D	E	F	G	重量(kg) Weight
33014-30	MCL-VV30	190	73	70	35	35	38	0 - 100	4.6
33014-40	MCL-VV40	230	98	80	40	40	46	0 - 125	11.4
33014-50	MCL-VV50	300	125	98	48	50	60	0 - 160	18.5
33014-60	MCL-VV60	350	150	100	50	50	60	0 - 210	24.9

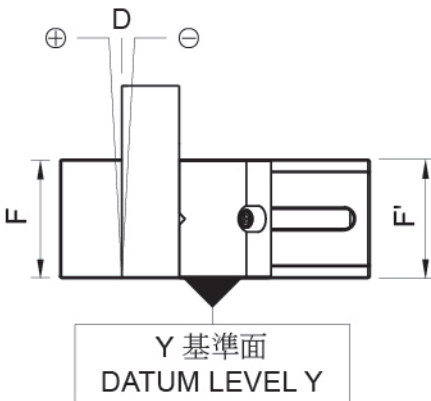

Y 基準面
DATUM LEVEL Y

檢驗項目 INSPECTION ITEMS		公差 TOLERANCE
A	垂直度對 X 基準面 VERTICAL AGAINST DATUM LEVEL X	± 0.004mm
B	垂直度對 X 基準面 VERTICAL AGAINST DATUM LEVEL X	± 0.004mm
C	垂直度對 X 基準面 VERTICAL AGAINST DATUM LEVEL X	± 0.004mm
D	垂直度對 Y 基準面 VERTICAL AGAINST DATUM LEVEL Y	± 0.004mm
E	平行度對 X 基準面 PARALLEL AGAINST DATUM LEVEL X	0.003mm
F	平行度對 Y 基準面 PARALLEL AGAINST DATUM LEVEL Y	0.003mm

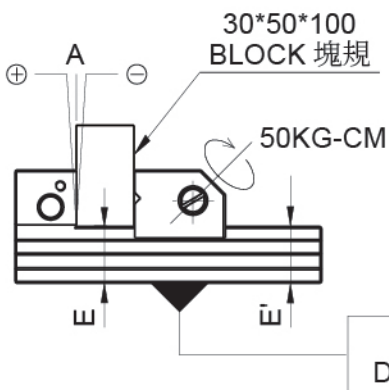

X 基準面
DATUM LEVEL X

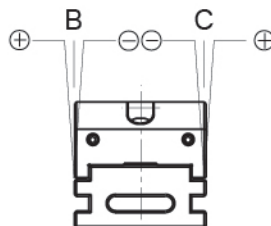



精密工具萬力(超特級品) SUPER FINE TYPE PRECISION TOOL MAKER VISE

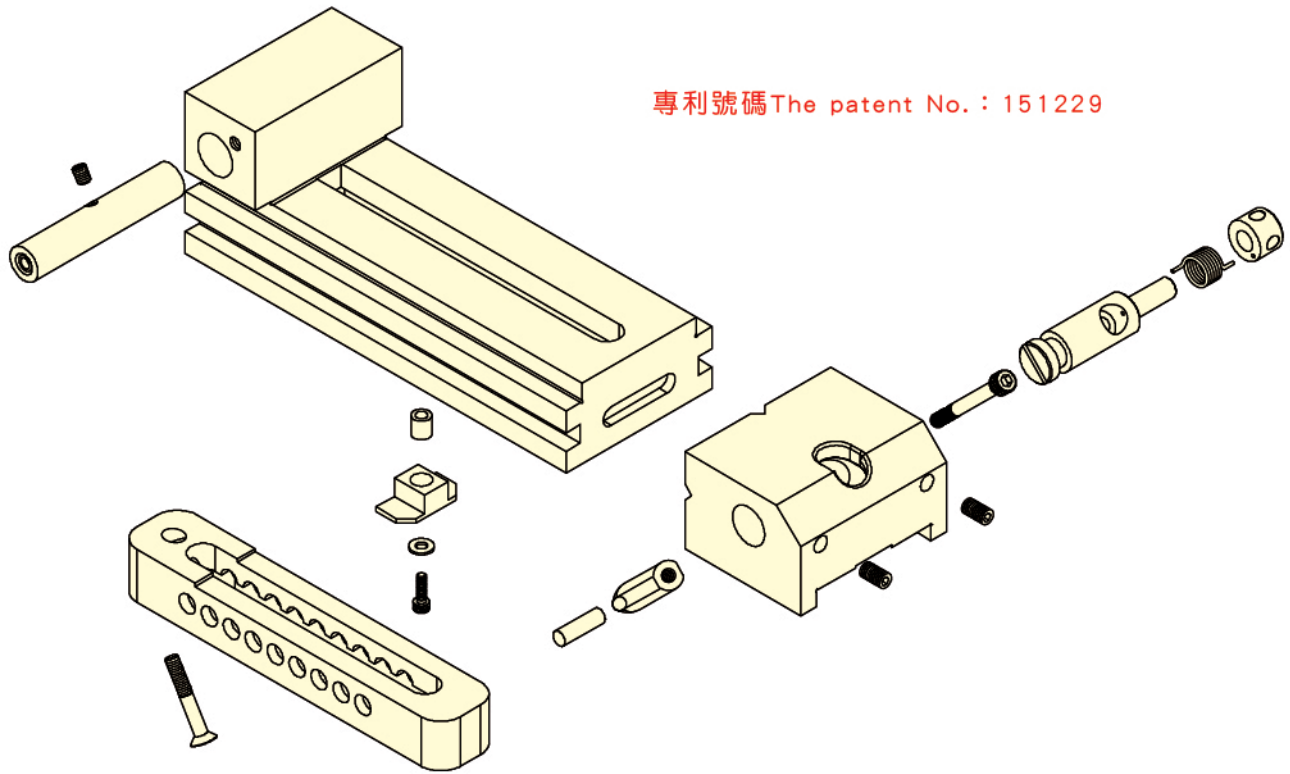

專利號碼 The patent No. : 151229

** 精密工具萬力(超特級品) **

** SUPER FINE TYPE PRECISION TOOL MAKER VISE **

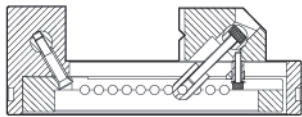

說明: 此款超精密工具萬力在未挾持工件而無應力的狀態。
Explanation: New developed VV30 Tool Maker Vise, there's no stress under unclamping situation.

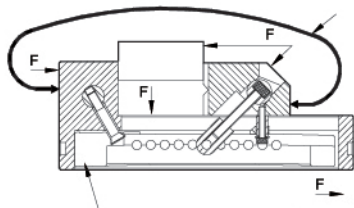

說明: 超精密工具萬力因夾持工件產生應力時的狀態。內槽座因承受應力而變形,但是精密萬力的外觀以及工件的外觀並未產生彎曲變形,故其夾持能力將獲得改進而大幅提高精密度。
Explanation: New developed VV30 Tool Maker Vise, it is at a stress status due to clamping work piece. Inner chute is transfigured by stress. But appearances of the vise and work piece are not out of sharp. Thus precision can be improved and raised.

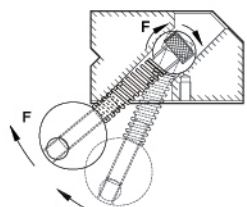

說明: 當固定軸受到彈簧所施加的壓力時,將產生一旋轉扭力,將螺絲往上彈與內槽座緊密結合在一起,產生向上彈性結構。
Explanation: When the pin is pressed by spring, the force will rebound the screw and connect it with inner chute tightly. An upper-rebound structure is caused.

** 普通型工具萬力 **

** REGULAR TOOL MAKER VISE **

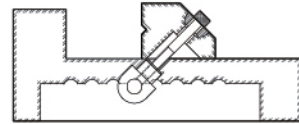

說明: 舊型的工具萬力在未挾持工件而無應力的狀態。
Explanation: Old type Tool Maker Vise, there's stress status due to clamping work piece.

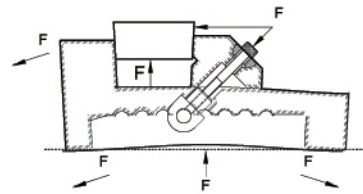

說明: 舊款工具萬力因夾持工件產生應力時的狀態。工具萬力的外觀與工件的外觀皆因應力而產生彎曲變形,故其夾持精密度較不理想。
Explanation: Old type Tool Maker Vise, there's stress status due to clamping work piece. Appearances of the vise and work piece are out of shaped by stress. The precision is not perfect.

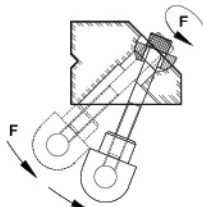

說明: 舊款工具萬力在螺絲放鬆時,插銷螺帽會往下掉,不會自動去定位,需要用人手去定位。
Explanation: When the screw is loosened, the nut of pin falls down, without auto positioning. Need positioning by hands.