

32010

鑽石修整器 DIAMOND CBN FLAT WHEEL TRUER

● MCL-ET100



● MCL-ET110.MCL-ET220

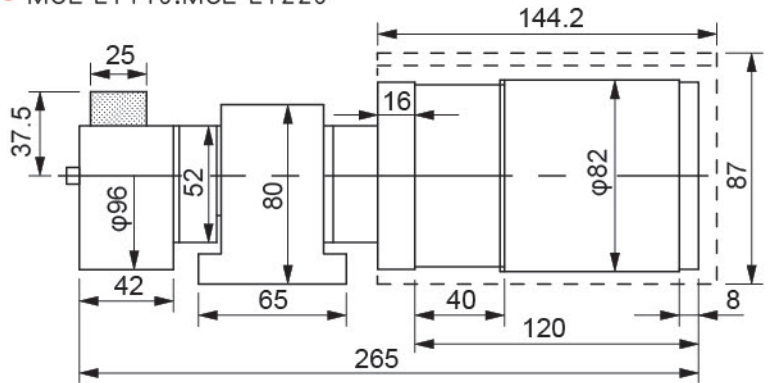

● MCL-ET100

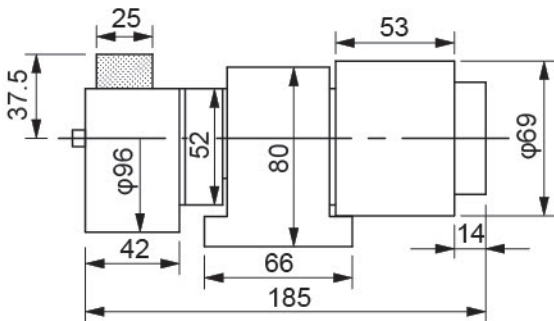

- 利用樹脂砂輪磨料，專門修整鑽石平面砂輪用。
- 主軸採精密軸承可高速旋轉，可確保精度及穩定性。
- The grinding wheel is made of resin, especially for diamond flat wheel.
- The spindle could be milled high-speed rotation with precision bearings. To ensure accuracy and stability.

單位:mm

訂購編號 Order No.	型號 Model	馬達 Motor	重量(kg) Weight
32010	MCL-ET100	-	4.5
32010-11	MCL-ET110	110V/60Hz 單相(1Phase)	6.5
32010-22	MCL-ET220	220V/60Hz 單相(1Phase)	6.5

32018

透視砂輪修整器 OPTICAL RADIUS ANGLE DRESSER

● MCL-E180

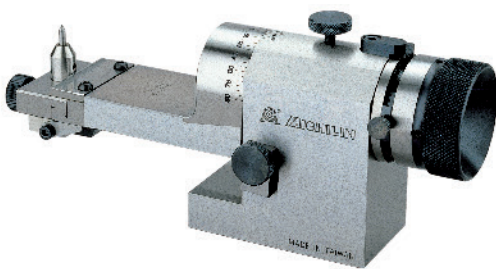

- MCL-E180 Visit Universal Wheel Dresser Adoptable on Surface grinder and universal tool grinder for dressing grinding wheel into various cross sections of flat or curved shapes.
- By "SIGHTING" the diamond point through the lens, radial and angle can easily be made perfectly tangent-Visually-Even with diamonds. Likewise radial can be blended together with most unbelievable accuracy.

- 適用於平面磨床和萬能工具磨床。
- 可修整各種角度和凸凹R，並可透過視鏡觀察鑽石筆尖修整砂輪表面接觸之情形，可精確的修整細小圓弧或度。

■規格:

- 中心高度:65mm
- 最大修整砂輪範圍:φ 200mm
- 凸R修整最大半徑:10mm
- 凹R修整最大半徑:24.4mm
- 滑板修整行程:22.5mm
- 修整角度:90° ~0° ~95°
- 重量:4.2kg

■Specifications:

- Center height:65mm
- Max. wheel diameter:φ 200mm
- Max. convex radius:10mm
- Max. concave radius:25.4mm
- Tangential travel:22.5mm
- Dressing angle:90° ~0° ~95°
- Weight:4.2kg

